

PROLIGHT+ BASIC



DATA SHEET

LINEAR PROFILE LED PRC3535 PROLIGHT+

LED PROFILE :

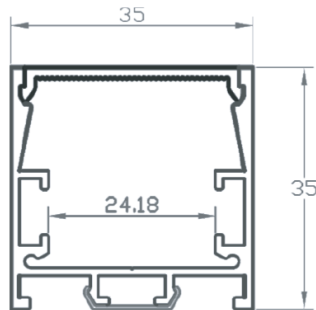

SPECIFICATIONS :

Application	Surface or Pendant
Material	Aluminum 1060 & PC
Surface processing	Silver Anodization
Longueur	2m
Length	Silver
Color	Frosted - Milky
Accessories	Metal end cap+screws, Mounting clip, steel rope, connectors
Strip Led	2 lines of LED Strip (Better to use 120pcs led/m to avoid dots)
Power	Max 28.8W/M
IP Rating	IP20

SERVICE ENVIRONMENT AND INSTALLATION:

1 With clip(Standard)

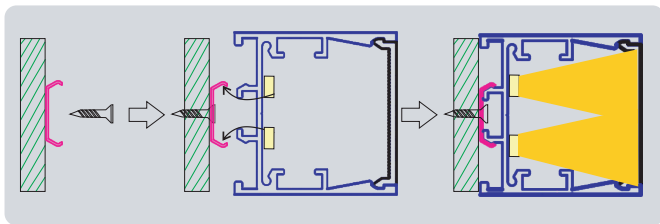

2 With Connector



3 With Steel Rope:

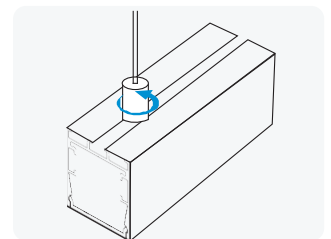

Slide the suspension kits bottom joiner into the alu base and rotate the joiner until locked into place.

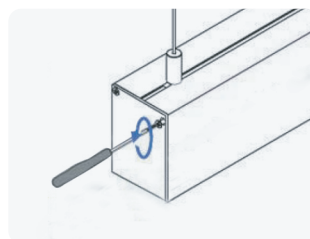

Screws the end caps

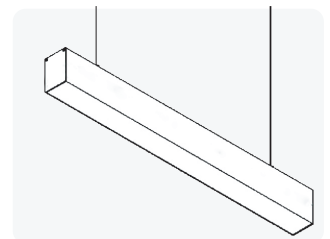

Fix the top joiner to the ceiling. Adjust the cable length to suit

PROLIGHT

BASIC+



DATA SHEET

LINEAR PROFILE LED PRC3535 PROLIGHT+

ACCESSORIES:

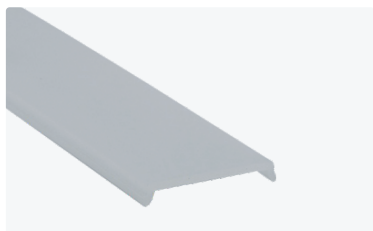

·Milky PC Cover

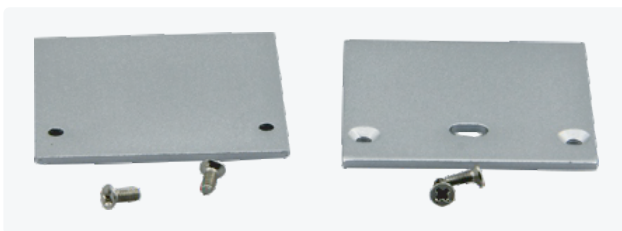

·Metal end caps and screws(M2*5)



·Metal mounting clip(standard)



· Connector
A) Direct
B) 90 inside
C) 90 outside

